



Feature



- Designed for long haul Gigabit Ethernet 100/1000Base-T, full Quad channels applications.
- Supports PoE+ and Auto MDIX in 16 pairs of category 5 UTP cable
- Cable interface for isolation and low common mode emissions
- Compliant with IEEE 802.3ab standard for 1000Base-T
- Comply with ROHS & Halogen Free requirements.
- Patented product.

Electrical Specifications@25°C

Part Number	Insertion Loss (dB Max)			OCL(uH Min) @100KHz/0.1V With 8mA DC Bias	DCR Imbalance	DCR (1/2 Winding)	DC Current/Voltage Rating - PSE PINS mA MAX @ 57 V (Continuous)	Input - Output Isolation
	1-30MHz	100MHz	125MHz					
ML96T02RS	-1.0	-1.4	-3.0	350	±0.065	0.65	840	1500

Continue

Part Number	Return Loss (dB Min)					Cross talk (dB Min)				Common Mode Rejection Ratio(dB Min)				
	1MHz	30MHz	60MHz	80MHz	100MHz	1MHz	30MHz	60MHz	100MHz	125MHz	250MHz	375MHz	500MHz	625-1000MHz
ML96T01RS	-20	-18	-14.4	-12	-10	-50	-43	-38	-33	-30	-25	-22	-17	-10

Schematic

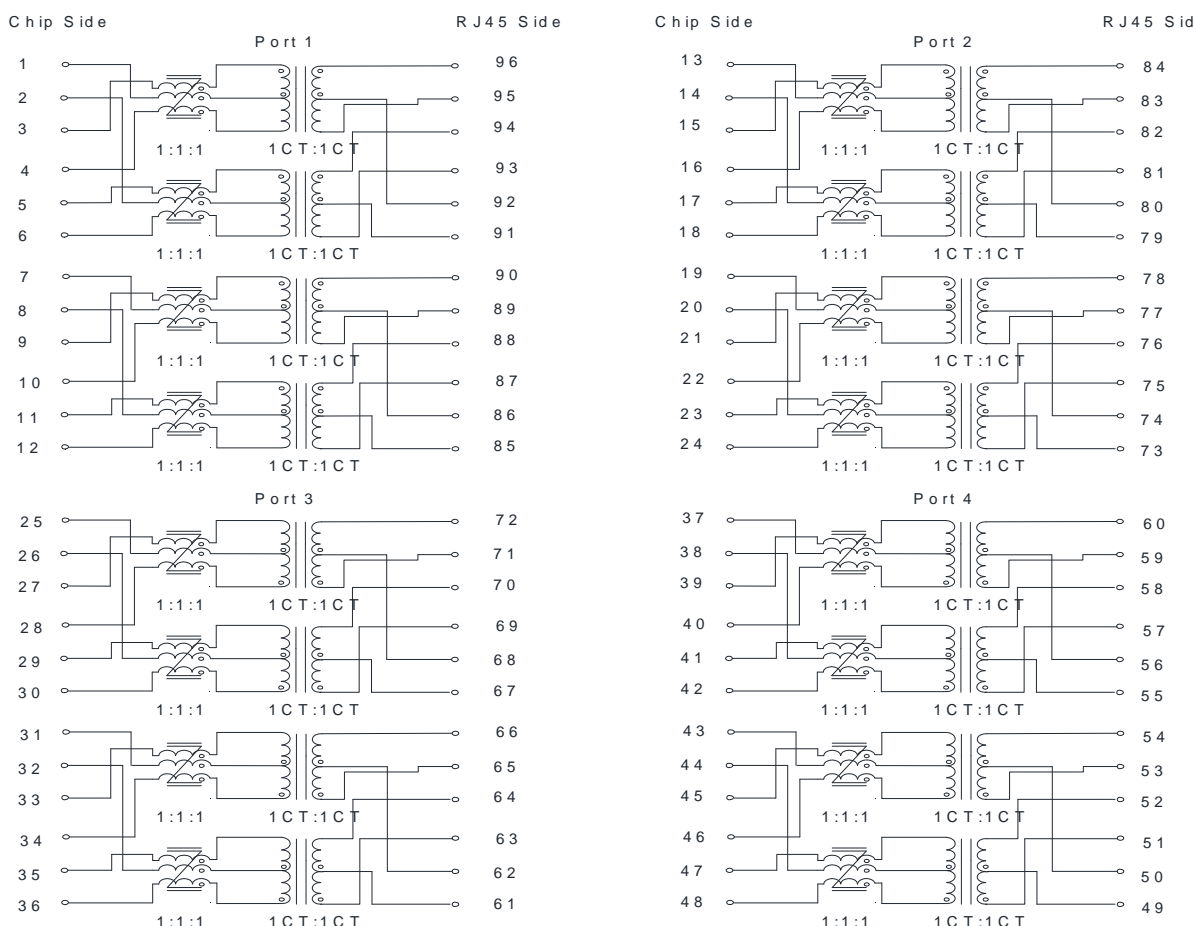



Mechanical

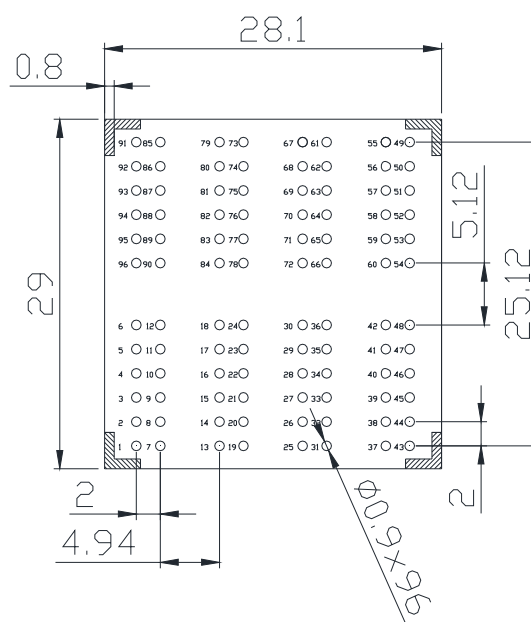
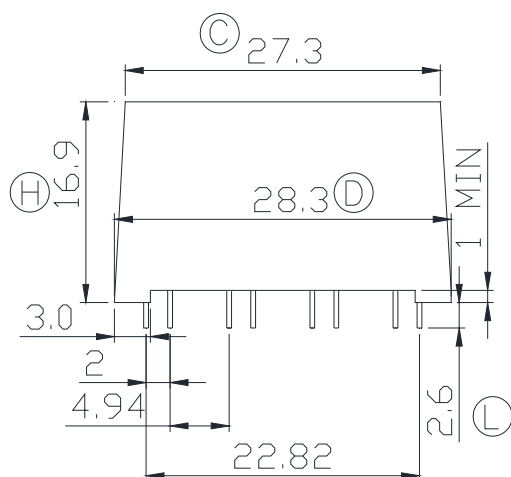
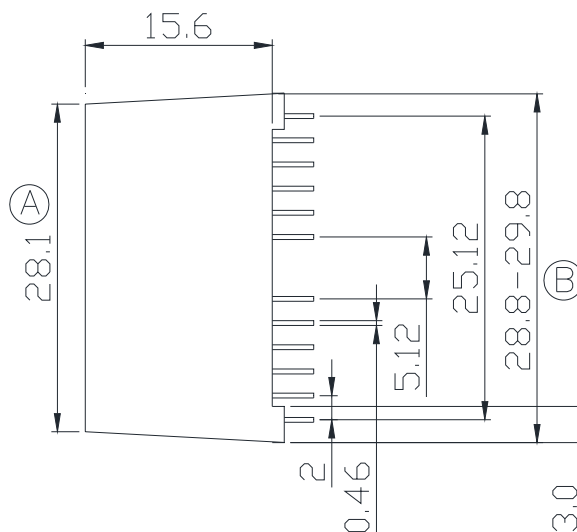
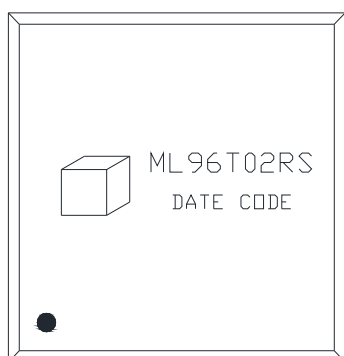

NO COMPONENT AREA.
Suggested Customer PCB Layout
(Component Side)

Dimension:mm(inch)Unless otherwise specified ,
all tolerance are +/-0.25(0.01)