

# GP Component

| REV. | ECN NO. | LOCATIONS | DESCRIPTION | DATE       | DESIGN      |
|------|---------|-----------|-------------|------------|-------------|
| A0   |         |           | Initial     | 2018/04/10 | Summer Wang |

## 1. MECHANICAL:

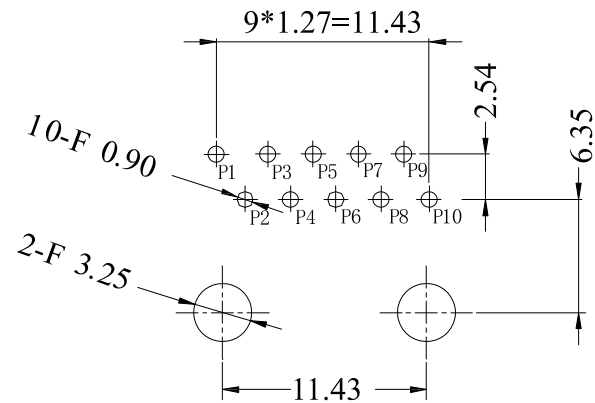
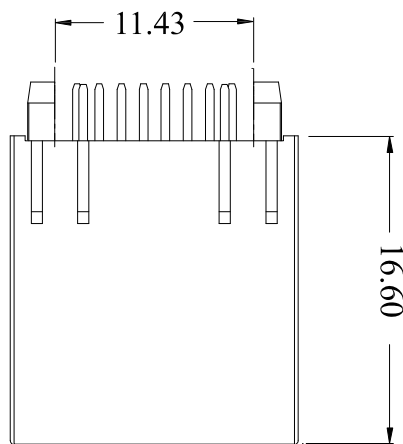

SUGGESTED PCB LAYOUT (TOP VIEW)

DIMENSIONAL TOLERANCE: .XX ±0.05

## Feature:

- Complies with IEEE standards and all Gigabit specifications including 350uH with 8mA DC bias
- Integrated Mag-modular design provides higher reliability and conserves minimizing PCB space
- Housing: Thermoplastic PBT UL94V-0, BLACK
- Contact :Phosphor Bronze( C5191),Gold plated on contact area 6u" Min
- Input Terminal : Brass(C2680)
- Metal shielding: Copper alloy with Nickel plated(C2680),
- Different color of LEDs option available
- Operating temperature: 0°C to +70°C
- Storage temperature: -40°C to +85°C

Lead-free process,compliant RoHS



Matrix Electronics Co.,Ltd

|   |               |            |   |
|---|---------------|------------|---|
| <b>TOLERANCE:</b><br>X:X ±0.38<br>X:XX ±0.25<br>X:XXX ±0.13<br>ANGLE: ±3° | DESIGN BY :   | DATE :     | <b>PART NAME:</b><br>RJ45, 1X1 TAB DOWN<br>10/100/1000 MHZ FILTER |
|   | Summer Wang   | 2018/04/10 |   |
|   | CHECKED BY:   | DATE :     | <b>PART NO.</b> MRJG-11T831RS                                     |
|   | Janice Liu    | 2018/04/10 |   |
|   | APPROVED BY1: | DATE :     | <b>MOLD NO.</b> NA  |
|   | Richard Hsieh | 2018/04/10 |   |
| UNIT: mm [inch]   | APPROVED BY2: | DATE :     | <b>DRAW NO.</b>   |
|   | Richard Hsieh | 2018/04/10 |   |
| SCALE:1:1   | SIZE:A4       |            | <b>SHEET NO.</b> 1 of 2   |

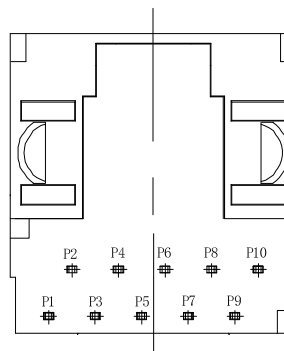
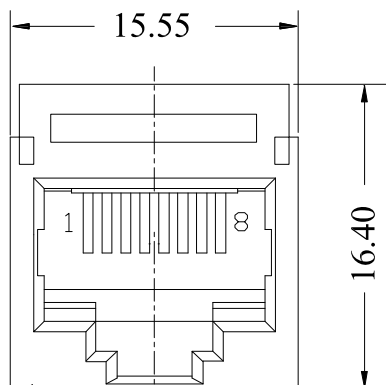
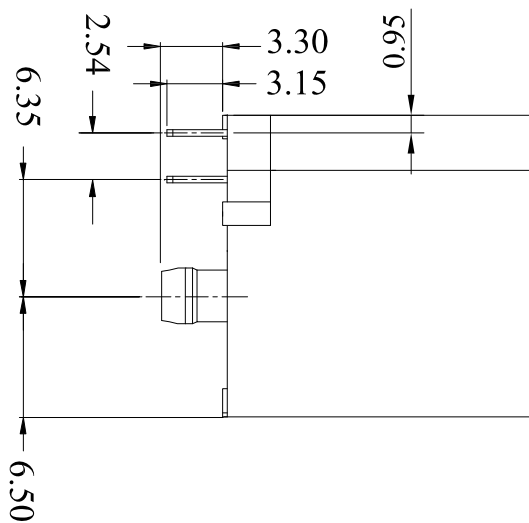

# GP Component

| REV. | ECN NO. | LOCATIONS | DESCRIPTION | DATE       | DESIGN      |
|------|---------|-----------|-------------|------------|-------------|
| A0   |         |           | Initial     | 2018/04/10 | Summer Wang |

## 2. SCHEMATIC:

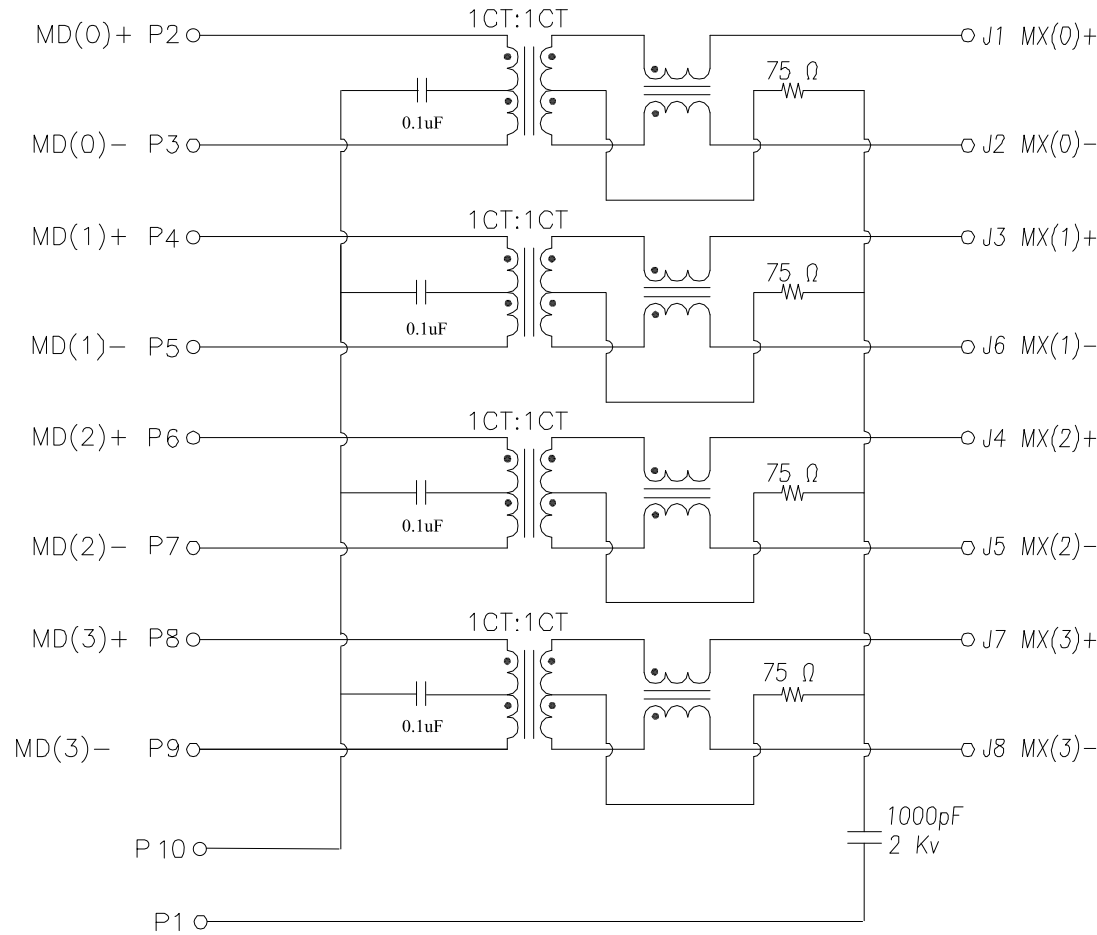

### ORDER INFORMATION :

M R J G - 1 1 T 831 R S  
 Matrix-RJ45  
 F : 10/100  
 G : 10/100/1000  
 N : Pure Connector  
 RS : ROHS  
 HF : Halogen Free  
 Series Number  
 S : SMD  
 T : THT  
 11: 1X1 ; 21: 2X1  
 12: 1X2 ; 22: 2X2  
 14: 1X4 ; 24: 2X4  
 16: 1X6 ; 26: 2X6  
 18: 1X8 ; 28: 2X8  
 1U: RJ+USB

## 3. ELECTRICAL CHARACTERISTICS :

- TR: (100KHz, 0.1V); 100%  
 PINS: (P2, P3): (J1, J2) = 1:1 ± 3%; (P4, P5): (J3, J6) = 1:1 ± 3%  
 PINS: (P6, P7): (J4, J5) = 1:1 ± 3%; (P8, P9): (J7, J8) = 1:1 ± 3%
- LX: (100KHz, 100mV, 8mA, DC Bias) 100%  
 PINS: (P2, P3), (P4, P5) = 350uH MINIMUM  
 PINS: (P6, P7), (P8, P9) = 350uH MINIMUM
- DCR: 100%  
 PINS: (J1, J2), (J3, J6) = 1.2 Ω MAXIMUM  
 PINS: (J4, J5), (J7, J8) = 1.2 Ω MAXIMUM
- HIPOT: 100%  
 PINS (P2, P3) TO (J1, J2), (P4, P5) TO (J3, J6) = 1500VAC FOR 60 SECONDS  
 PINS (P6, P7) TO (J4, J5), (P8, P9) TO (J7, J8) = 1500VAC FOR 60 SECONDS
- INSERTION LOSS:  
 -1.0dB MAXIMUM AT 1MHz TO 100MHz;  
 -1.2dB MAXIMUM AT 100MHz TO 125MHz;
- RETURN LOSS:  
 -16dB MINIMUM AT 1MHz TO 40MHz;  
 -12dB MINIMUM AT 40MHz TO 60MHz  
 -10dB MINIMUM AT 60MHz TO 80MHz  
 -8dB MINIMUM AT 80MHz TO 100MHz
- CROSS TALK:  
 -30dB MINIMUM AT 1MHz TO 100MHz
- COMMON TO COMMON MODE REJECTION:  
 -30dB MINIMUM AT 1MHz TO 100MHz



Matrix Electronics Co., Ltd

|   |                                       |                             |  |
|---|---------------------------------------|-----------------------------|--|
| <b>TOLERANCE:</b><br>X: X<br>X.X ±0.38<br>X.XX ±0.25<br>X.XXX ±0.13<br>ANGLE: ±3° | <b>DESIGN BY :</b><br>Summer Wang     | <b>DATE :</b><br>2018/04/10 | <b>PART NAME:</b><br>RJ45 1X1 TAB DOWN<br>10/100/1000 MHZ FILTER |
|   | <b>CHECKED BY:</b><br>Janice Liu      | <b>DATE :</b><br>2018/04/10 | <b>PART NO.</b><br>MRJG-11T831RS                                 |
| <br><b>UNIT: mm [inch]</b><br><b>SCALE: 1:1 SIZE: A4</b>                          | <b>APPROVED BY1:</b><br>Richard Hsieh | <b>DATE :</b><br>2018/04/10 | <b>MOLD NO.</b><br>NA  |
|   | <b>APPROVED BY2:</b><br>Richard Hsieh | <b>DATE :</b><br>2018/04/10 | <b>DRAW NO.</b><br><b>SHEET NO.</b> 2 OF 2                       |